

**SPECIFICATION DATA**

# IPE-100X200



## Product Details

- Protect electrical equipment from environmental factors like water, dust, and accidental contact.
- Secures system in place for a better and stable inspection.
- Comply with IP68 which offers complete protection against dust and protection against high-pressure water jets from any direction.
- Compatible on a moving robot arm.

## Features & Benefits

- Made of Stainless Steel 304 grade.
- Supplied with silicon o-ring & polycarbonate mirror.
- Supplied with certified IP54 split cable gland.
- Come with 3X M5 nuts welded on the casing for machine assembly.
- Compact with camera mounting.
- “PLUG AND PLAY” design.
- Customized unit available to fit special lighting, camera and lens.

### Ingress Protection(IP) Enclosure Specifications

Material	Stainless Steel 304
Color	Shining metal
Protection Level	IP68
Length(mm)	226
Width(mm)	98
Height(mm)	98
Cable Holes	4
Compliance	CE, RoHS, REACH
Accessories	Cable Gland & Camera Mounting

**IPE Dimension Layout**

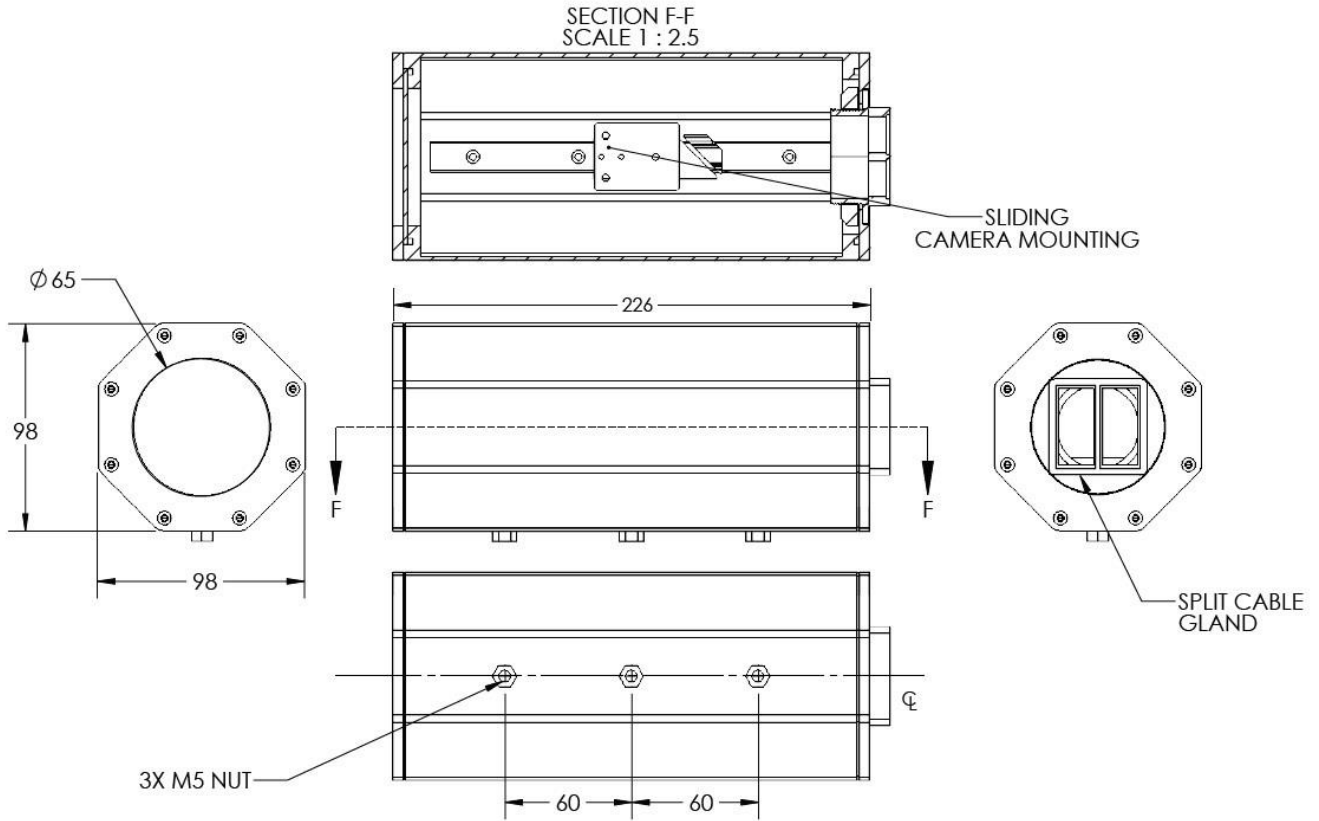

**Packing list**



No.	Items	Quantity
1.	IPE-100X200	1